

SPD Pedals PD-MX70

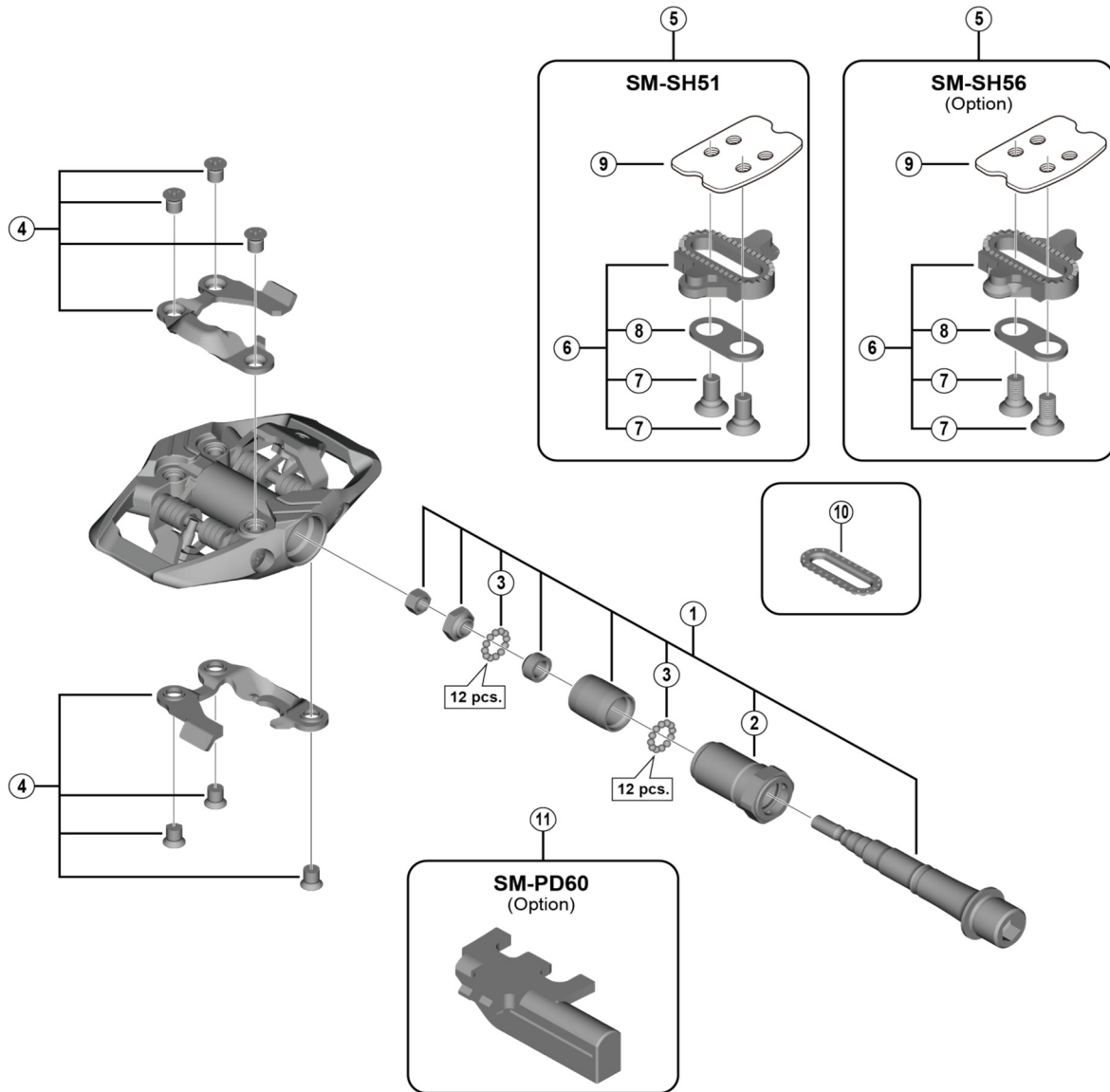

PD-M8020
PD-M8000

ITEM NO.	SHIMANO CODE NO.	DESCRIPTION	INTERCHANGEABILITY	
			PD-M8020	PD-M8000
1	YL8F98010	Pedal Axle Assembly (Right / B.C.9/16" x 20T.P.I.)		
	YL8F98020	Pedal Axle Assembly (Left / B.C.9/16" x 20T.P.I.)		
2	YL8F98030	Lock Bolt (Right)		
	YL8F98040	Lock Bolt (Left)		
3	Y41N98030	Steel Ball (3/32") 62 pcs.	A	A
4	Y41U98090	Body Cover (Right) & Fixing Bolts (M5)	B	B
	Y41U98100	Body Cover (Left) & Fixing Bolts (M5)	B	B
5	Y42498220	SM-SH51 Cleat Set (Single Release Mode / Pair)	A	A
	Y41S98092	SM-SH56 Cleat Set (Multiple Release Mode / Pair)	A	A
6	Y42498201	SM-SH51 Cleat Set w/o Cleat Nut (Single Release Mode / Pair)	A	A
	Y41S98100	SM-SH56 Cleat Set w/o Cleat Nut (Multiple Release Mode / Pair)	A	A
7	Y41704030	Cleat Fixing Bolt (1 pc.)	A	A
8	Y42423000	Cleat Adapter (1 pc.)	A	A
9	YL0E04000	Cleat Nut (1 pc.)	A	A
10	YL8098030	SPD Cleat Spacer (2 pcs.)	A	A
11	Y40Z98010	SM-PD60 Reflector Unit Standard/AS(Pair/Option)	A	A

A: Same parts.

B: Parts are usable, but differ in materials, appearance, finish, size, etc.

Absence of mark indicates non-interchangeability.

Specifications are subject to change without notice.

Nov.-2018-4345

© Shimano Inc. I

SHIMANO